

## *Lite-Site 25*

CDMI's Lite-Site 25 is heavy-duty on-grade foundation system that supports our Lite-Pole monopoles – up to a height of 150 feet plus AGL – all within a 25 ft x 25 ft footprint.

Lite-Site 25 is professionally engineered to be utilized as a permanent or temporary site. Its rigid design allows it to support multiple carriers even in high wind regions.

Need to restore communication service? Lite-Site 25 is often used to provide temporary relief when suffering the loss of a leased tower, special events, disaster recovery, or when relocating multiple carriers off a water tank or building.

Lite-Site 25 is the preferred on-grade foundation system by construction crews for its simplistic design and quick assembly. Lite-Site 25 is often erected in one day!



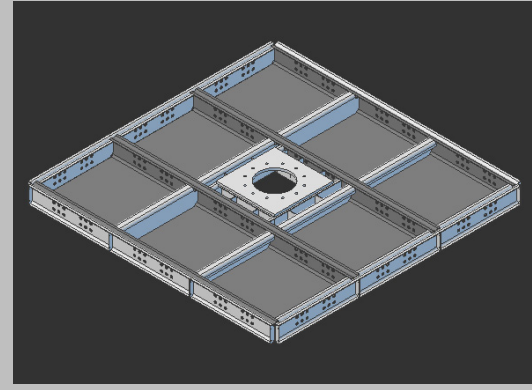
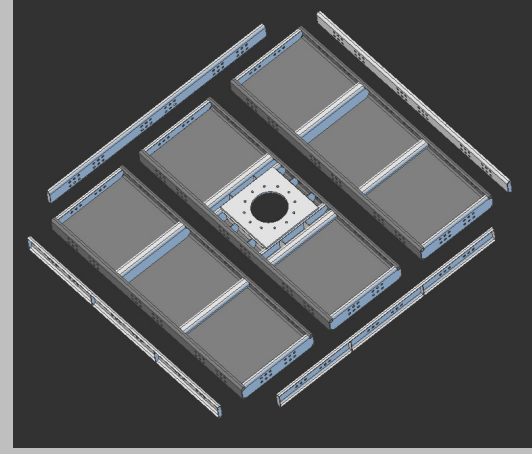
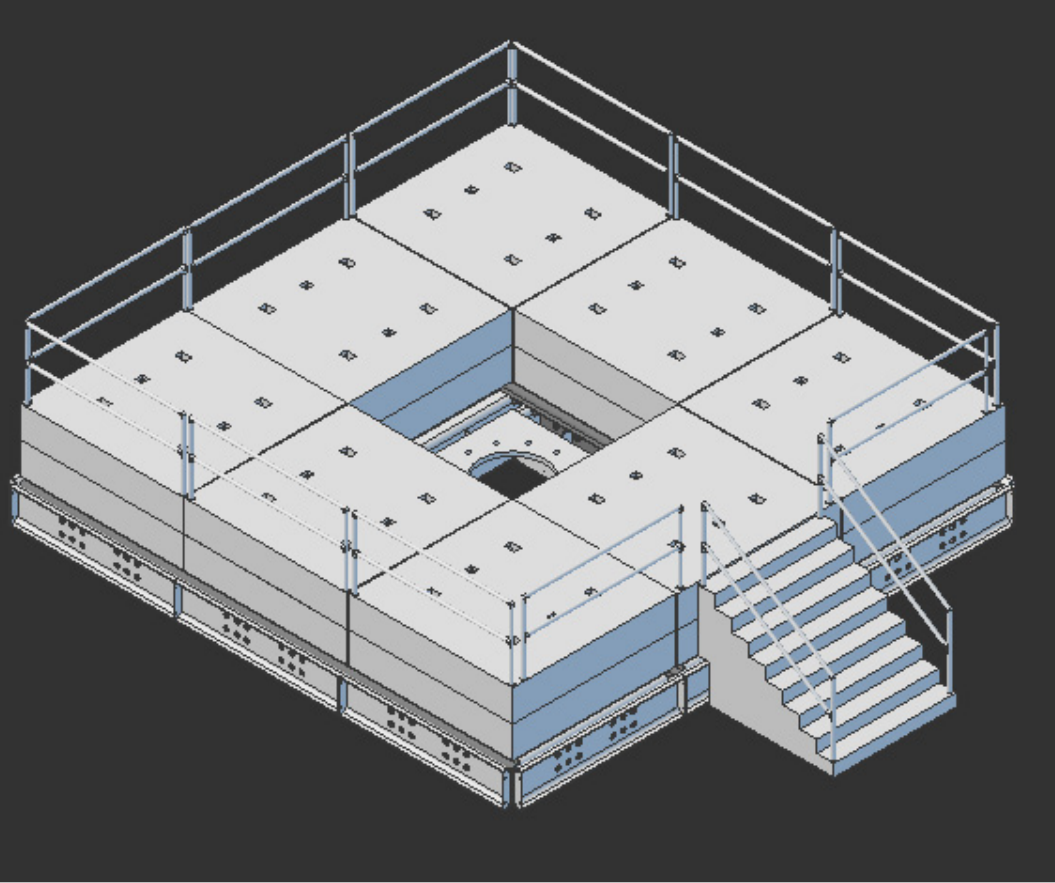

*The Lite-Site 25 consists of 3 trays and 4 channels that bolt together to form the on grade foundation. One tray contains the welded base plate where the anchor bolts and monopole are attached. The base plate tray can be mounted on either the center or an edge of the foundation. Both perimeter rails and trays are symmetrical to ensure easy installation. The entire foundation assembly can be completed in a few hours.*

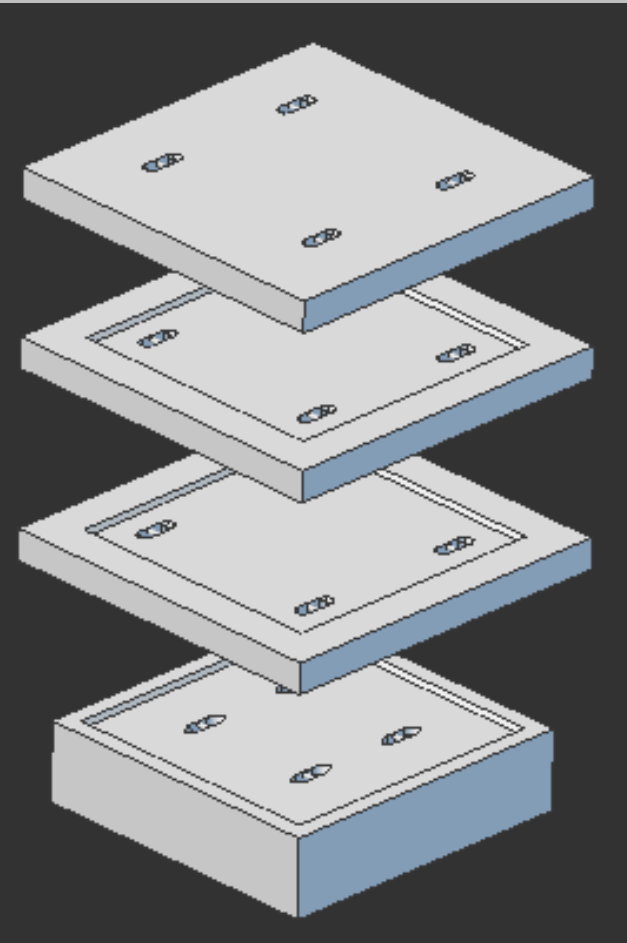

*The Lite-Site 25 ballast blocks are stackable to achieve a series of different foundation weight. The main bottom block and first layer equals 150,000 lbs of ballast and is the minimum weight available. Each additional layer of ballast adds 50,000 lbs of weight to the foundation. The maximum ballast weight is 320,000 lbs. Wind loading, number of carriers and location of the site determines how much ballast is required to support the monopole.*

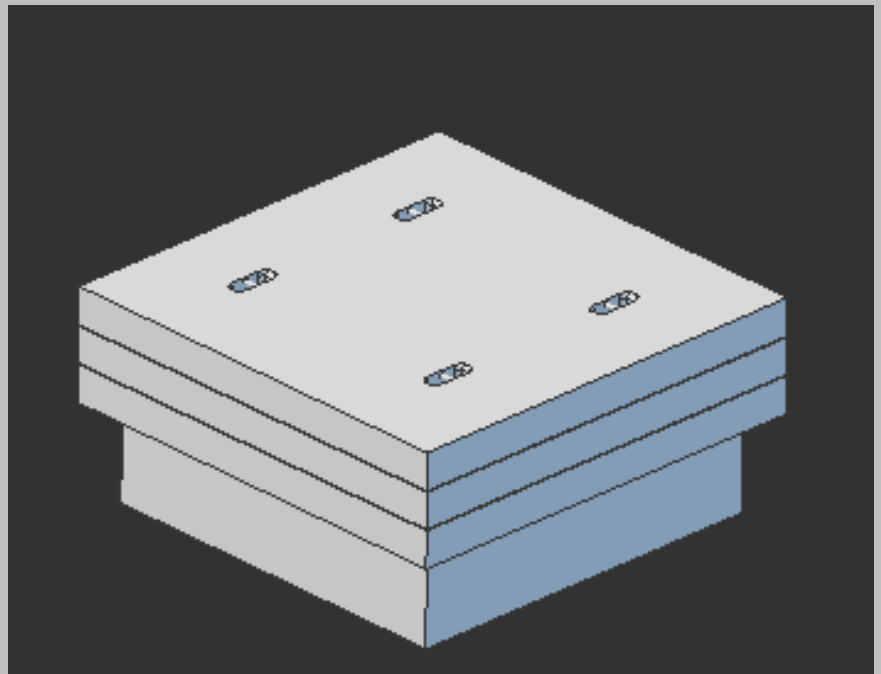

# Lite-Site 25

## Measurements

- *Assembled Foundation - 25' sq*
- *Foundation Height - 1'-8"*
- *Foundation Height w/ Ballast - 2'-7" ~ 5'-8"*

## Ballast Requirements

- *150,000 lbs min ~ 320,000 lbs max*
- *13,000 lb Bottom Block*
- *6,250 lb Middle & Top Finish Block*
- *320,000 lb assembly uses 8,750 lb Top Finish Block*

## Monopole

- *LP-STP46, LP-BTP46*
- *Slip Joint Tapered or External Flanged Bolt Together*
- *Heights from 25' to 150' in 25' increments.*

## Overturning Moment (OTM)

- *Centered Monopole - 3,300 ft kips*
- *Edge Mounted Monopole - 2,200 ft kips*

## Soil Bearing Pressure

- *1,500 psf max*

## Weights

- *Assembled Foundation - 38,440 lbs*
- *(4) Perimeter Channels - 1,480lbs ea (5,920 lbs)*
- *(2) Foundation Trays - 9,260 lbs ea (18,520lbs)*
- *Foundation Tray w/ Baseplate - 14,000 lbs*

## CDMI Wireless

*Creative Design & Machining Inc.*

*969 Griffin Pond Road*

*South Abington PA, 18411*

*570.587.3077*

*CDMI@Cdmewireless.com*

