

Lite-Site 15

CDMI's Lite-Site 15 is an on-grade foundation system that supports CDMI's Lite-Pole monopoles up to 100' AGL.

The Lite-Site 15 is a modular foundation system that when bolted together creates a 15' x 15' footprint with monopoles up to and sometimes exceeding 100' with medium to heavy loading.

As a temporary site, the Lite-Site 15 can be used for special events to extend coverage quickly, water tank or building maintenance or disaster recovery. The quick assembly and decommission paired with high loading capacity make the Lite-Site 15 an ideal choice for temporary relocation or adding coverage.

The Lite-Site 15 is engineered as a permanent site. There is no difference in deployment or construction between using the Lite-Site 15 as a temporary or permanent site. CDMI's on-grade foundation opens up site selection to areas where you can not break ground, have limited space or is very costly to drill a cassion foundation.



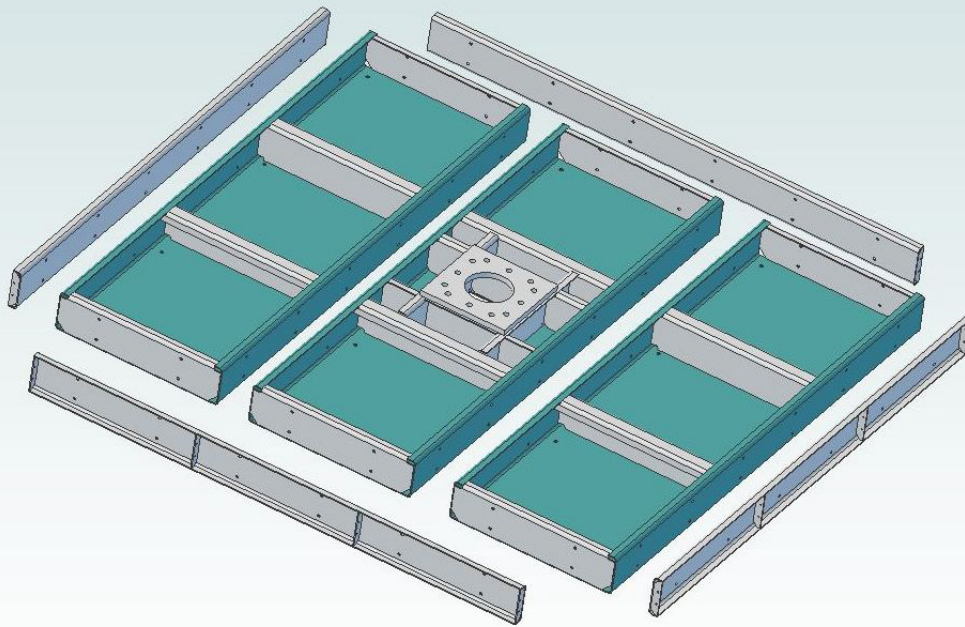

The Lite-Site 15 consists of 3 trays and 4 perimeter channels that bolt together to form the on-grade foundation. The baseplate tray can be mounted in the center of the foundation or in some instances on the edge of the foundation. Both the foundation trays and perimeter rails are symmetrical to ensure easy installation.

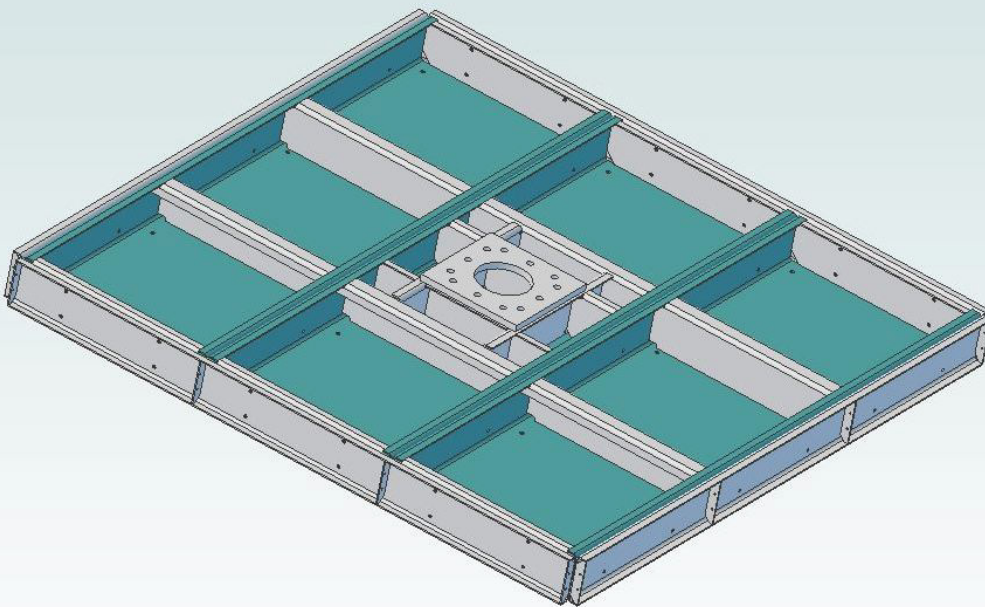

When the Lite-Site 15 Foundation is assembled, it creates a 15' x 15' footprint. Installation of the Lite-Site 15 takes no longer than a few hours. 8 Ballast blocks are then added and the monopole bolted to the foundation to complete the site.

Lite-Site 15

Measurements

- *Assembled Foundation - 15'-0" sq*
- *Foundation Height - 1'-3"*
- *Foundation Height w/ Ballast - 2'-6"*

Ballast Requirements

- *50,000 lbs evenly distributed to obtain a 475 OTM*
- *(8) Ballast block @ 6,250 lbs ea*

Monopole

- *LP-STP30, LPSTP30HD, LP-BTP30*
- *Slip Joint Tapered or External Flanged Bolt Together*
- *Heights from 25' to 150' in 25' increments.*

Overturning Moment (OTM)

- *Centered Monopole - 475 ft kips*
- *Edge Mounted Monopole - 340 ft kips*

Soil Bearing Pressure

- *1,500 psf max*

Weights

- *Assembled Foundation (Steel Only) - 9,400 lbs*
- *(4) Perimeter Channels - 375 lbs ea (1,500 lbs)*
- *(2) Foundation Trays - 2,180 lbs ea (4,360 lbs)*
- *Foundation Tray w/ Baseplate - 3,350 lbs*

CDMI Wireless
Creative Design & Machining Inc
969 Griffin Pond Rd
South Abington PA, 18411
570.587.3077
CDMI@CDMIWIRELESS.COM

